



# UPTON CITY PARK OPTION 5 14-3846B

Powder Coat



Chocolate



Spring



Green

Plastic



Brownstone



Green



Choc.-Beige Choc.

Deck



Brown



ADA Compliant





# UPTON CITY PARK OPTION 5 14-3846B

Powder Coat



Chocolate



Spring



Green

Plastic



Brownstone



Green



Choc.-Beige  
Choc.

Deck



Brown



ADA Compliant





# UPTON CITY PARK OPTION 5 14-3846B

**Powder Coat**



Chocolate



Spring



Green

**Plastic**



Brownstone



Green



Choc.-Beige  
Choc.

**Deck**



Brown



ADA Compliant





# UPTON CITY PARK OPTION 5 14-3846B

Powder Coat



Chocolate



Spring



Green

Plastic



Brownstone



Green



Choc.-Beige  
Choc.

Deck



Brown



ADA Compliant



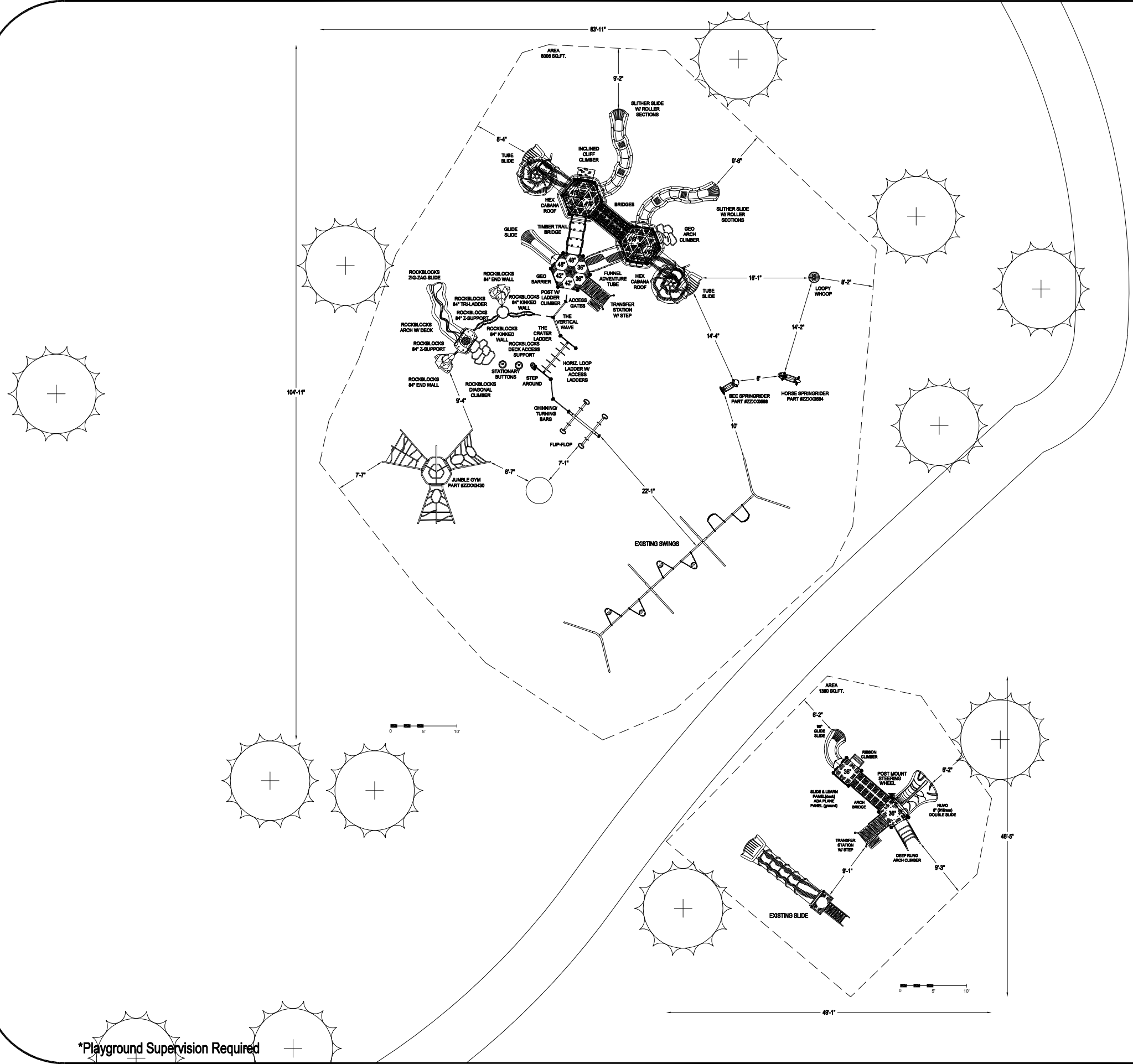

\*Playground Supervision Required

PROJECT NO: 14-3846.CPI	REV: B	DATE: 5-SEP-14
SYSTEM: CHALLENGERS		SCALE: 1/16" = 1'-0"
SITE PLAN		DRAWN BY: R. DIEFFENBACH

CHILDREN'S PLAYSTRUCTURES, INC.  
9892 Titan Park Circle, Unit 1  
Littleton, CO 80125

**PLAYWORLD™**

© 2013 Playworld Structures, Inc.  
Playworld® is a brand of Playworld Structures, Inc.

	ASTM F1487-11		N/A
	167 USERS		2-12
	9 FT.		SEE DWG
	SEE DWG		SEE DWG

# UPTON CITY PARK OPTION 5

UPTON, WY 82730

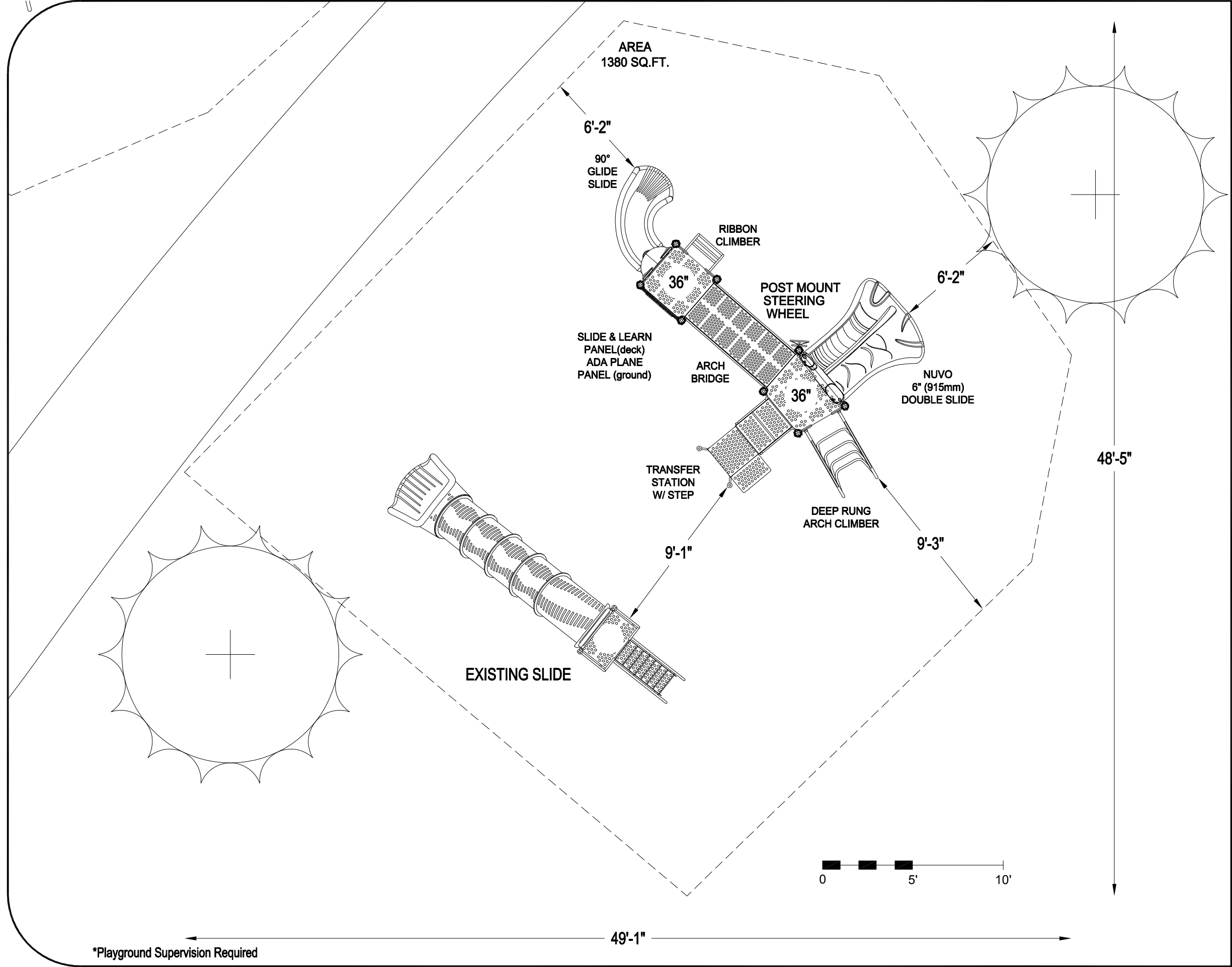

\*Playground Supervision Required

- ASTM F1487-11
- 2-12
- 167 USERS
- N/A
- SEE DWG
- SEE DWG
- 9 FT.
- 

CHILDREN'S PLAYSTRUCTURES, INC.  
 9892 Titan Park Circle, Unit 1  
 Littleton, CO 80125

**PLAYWORLD™**  
© 2007 Playworld Structures, Inc.  
 Playworld® is a brand of Playworld Systems, Inc.

PROJECT NO: 14-3846.CPI	REV: B	DATE: 5-SEP-14	SCALE: 3/16" = 1'-0"
SYSTEM: CHALLENGERS		DRAWN BY: R. DIEFFENBACH	
SITE PLAN			

# UPTON CITY PARK OPTION 5

UPTON, WY 82730

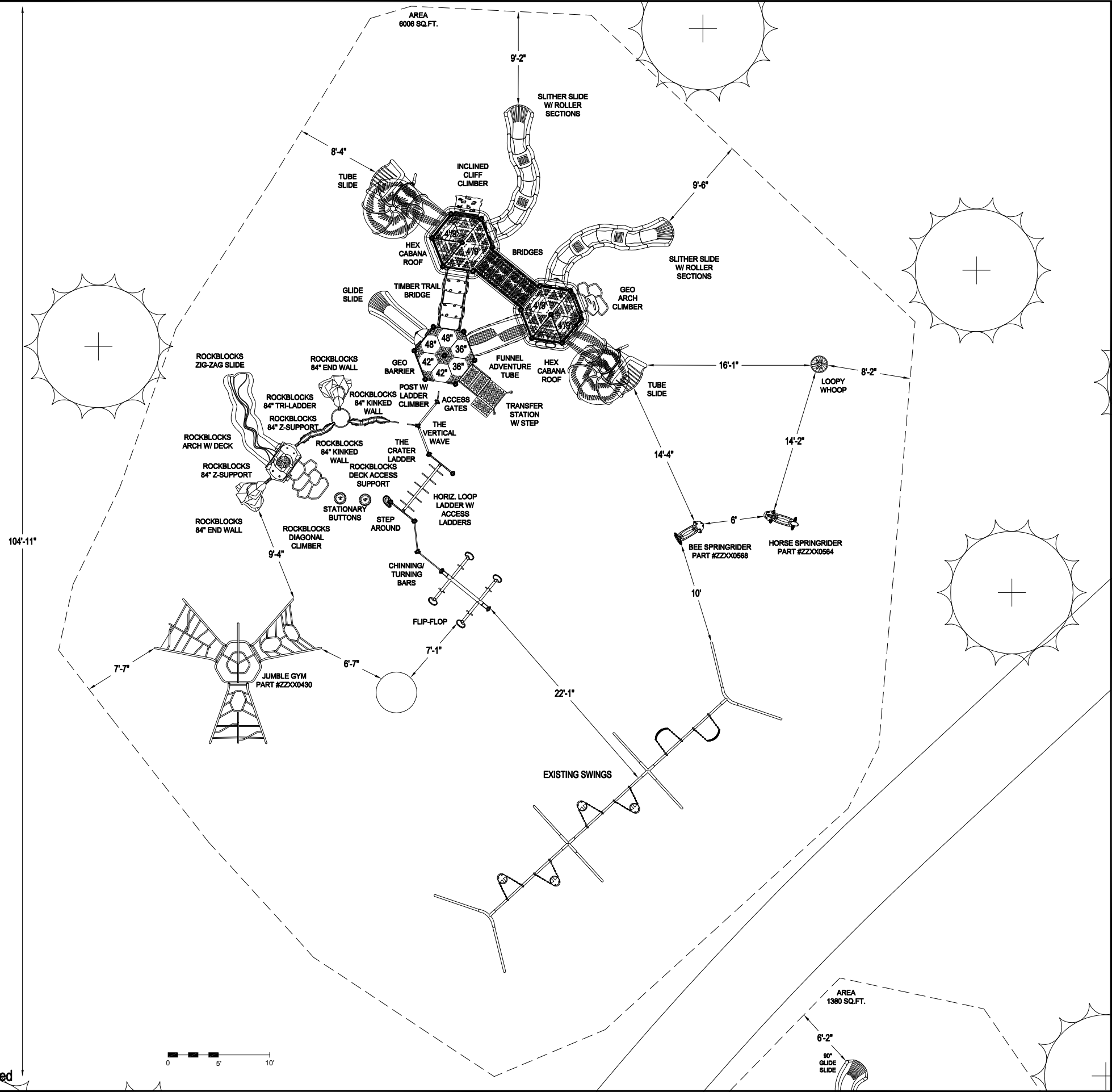

\*Playground Supervision Required

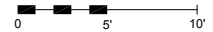

PROJECT NO: 14-3846.CPI	REV: B	DATE: 5-SEP-14
SYSTEM: CHALLENGERS		SCALE: 3/32" = 1'-0"
SITE PLAN		DRAWN BY: R. DIEFFENBACH

CHILDREN'S PLAYSTRUCTURES, INC.  
9892 Titan Park Circle, Unit 1  
Littleton, CO 80125

**PLAYWORLD™**

© 2013 Playworld Structures, Inc.  
Playworld® is a brand of Playworld Structures, Inc.

	ASTM F1487-11		N/A
	167 USERS		SEE DWG
	2-12		SEE DWG
			9 FT.

# UPTON CITY PARK OPTION 5

UPTON, WY 82730



GROUND-LEVEL

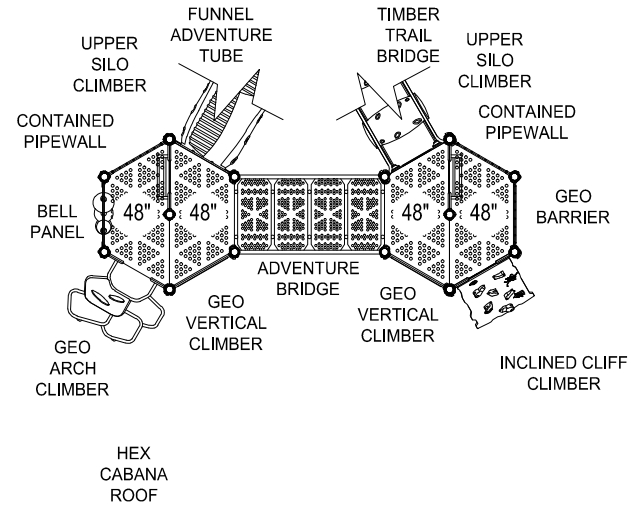

4' (1,22M) LEVEL

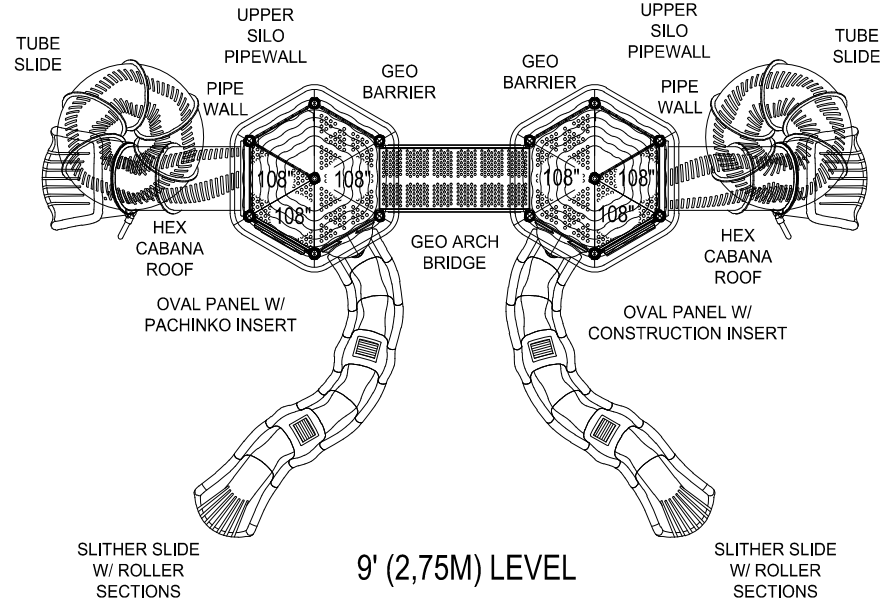

9' (2,75M) LEVEL

\*Playground Supervision Required

**NOTES:**

- 1) This tower detail is a diagram of the individual level layouts of the tower portion of your play structure, showing the detailed component layout of each level.
- 2) This tower detail is not to scale and is meant for reference purposes only. It should not be used in obtaining accurate measurements for any of the equipment shown unless otherwise noted on the drawing.
- 3) This design configuration is the property of this firm and Playworld Systems® and may not be reproduced or used in any manner without the expressed written consent of this firm and Playworld Systems®.

CHILDREN'S PLAYSTRUCTURES, INC.  
 9892 Titan Park Circle, Unit 1  
 Littleton, CO 80125



© 2007 Playworld Systems, Inc.  
 Playworld™ is a brand of Playworld Systems®, Inc.

PROJECT NO: 14-3846.CPI	REV: B	DATE: 5-SEP-14
DETAIL DETAIL X		SCALE: N/A
TOWER DETAIL		DRAWN BY: R. DIEFFENBACH

**UPTON CITY PARK OPTION 5**

UPTON, WY 82730